



LIVING HOTEL®

DÜSSELDORF



BERLIN / BONN / CAPE TOWN / DUSSELDORF / FRANKFURT / HAMBURG / MUNICH / NUREMBERG / VIENNA / WEIMAR

LIVING HOTEL DÜSSELDORF

Kirchfeldstraße 59-61
40217 Dusseldorf
+49 (0)211-41729-580
convention.sales.due@living-hotels.com
www.living-hotels.com

[more information](#)

Experience Dusseldorf where the city is most beautiful: at its heart. Make our Living Hotel your home. Make it your base for exploring Dusseldorf. We'll be waiting for you when you come home. With tailor-made services and all the space you need. With a team that embodies hospitality. You can look forward to modern, stylishly designed rooms and Serviced Apartments. To a warm welcome. No matter how long you're staying with us.

Living Hotel Dusseldorf has three multifunctional meetings rooms with plenty of natural light. We'll support you from start to finish. We can develop concepts and plans with you, host your event and ensure that everything is set up beforehand and taken down afterwards. Want your event to be a success? Then take advantage of our facilities!

We are looking forward to your visit!

Bojan Nikolic
General Manager



LIVING HOTEL DÜSSELDORF

General Information



ROOM 1

64 sqm
Room Size

40 Pers.
Max. occupancy

ROOM 2

67 sqm
Room Size

45 Pers.
Max. occupancy

ROOM 3

72 sqm
Room Size





45 Pers.
Max. occupancy

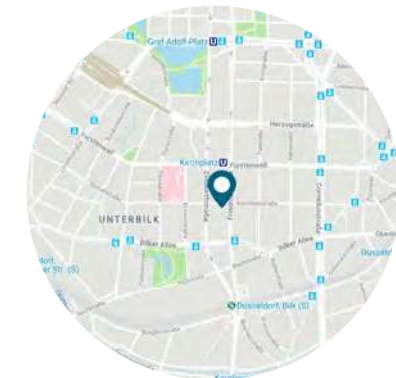

- > Central Station 2 km
- > Old Town / City Center 2 km
- > Airport Dusseldorf DUS 10 km
- > Fair / Congress center 7 km
- > Rhine promenade 2 km



- / Located in a quiet side street in Düsseldorf Bilk
- / 3 combinable event rooms with natural light
- / Conference foyer for your individual coffee break
- / Modern technical equipment
- / Separate entrance to the event area
- / Free upgrade for trainers or event managers

ROOM	ROOM SIZE				EQUIPMENT			SEATING				RENT	
	sqm	Height	Width	Lenght	Daylight	Blackout	Air-Condition					Whole Day	Half a Day
Room 1	64	2,60	6,10	10,50	x	x	x	24	40	20	20	upon request	
Room 2	67	2,60	6,70	10,00	x	x	x	24	45	20	24	upon request	
Room 3	72	2,60	6,30	11,50	x	x	x	24	45	24	28	upon request	
Room 1 to 2	131	2,60	12,80	10,25	x	x	x	56	80	32	36	upon request	
Room 2 to 3	139	2,60	13,00	10,70	x	x	x	56	80	32	36	upon request	
Room 1 to 3	203	2,60	19,10	10,65	x	x	x	90	140	44	48	upon request	

STANDARD EQUIPMENT

Included in conference packages and room rentals.

- / 1 Flipchart
- / 1 Pinboard
- / 1 Screen
- / 1 Beamer (Overhead on request)
- / 1 Presenter equipment
- / Blocks and pens

ADDITIONAL EQUIPMENT

On request and availability. Additional costs possible.

- | | | | |
|-----------------------|-----|--------------------------------|--------------|
| / Presenter equipment | 25€ | / Lectern | 85€ |
| / Beamer | 90€ | / TV with DVD-Player | upon request |
| / Flipchart | 25€ | / Microphone system | 385€ |
| / Pinboard | 20€ | (1 hand and 2 tie microphones) | |
| / Canvas | 80€ | / Sound engineer | upon request |

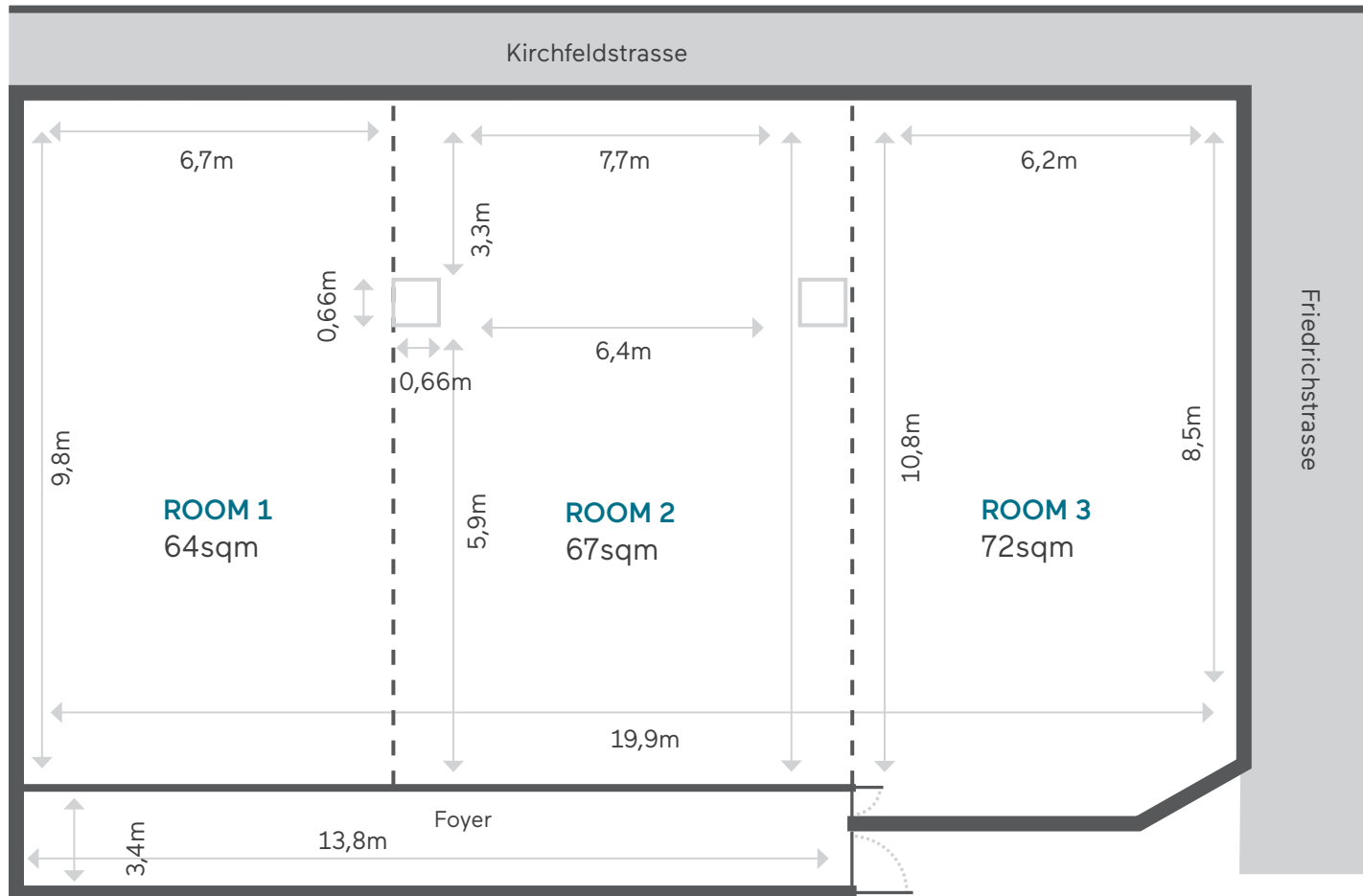

Room height 2,60m

SERVICES	STANDARD	BUSINESS	EXKLUSIV	HALF A DAY
Morning coffee break			✓	
Welcome coffee		✓		
Mid-morning coffee break incl. coffee specialties	✓	✓	✓	one coffee break in the mornig or afternoon
Afternoon coffee break incl. coffee specialties	✓	✓	✓	
Lunch 3-course menu or buffet (as of 15 persons)	✓	✓	✓	✓
Dinner (optional) 2 or 3-course menu	upon request	upon request	upon request	
Conference room Preperation of conference room (Additional costs depending on size)	✓	✓	✓	✓
Conference technology Beamer, screen, flip chart, blocks and pens, pinboard)	✓	✓	✓	✓
Conference beverages Water, apple juice	✓	✓	+ unlimited soft drinks	
Package per person in EUR incl. VAT. (as of 10 persons)				
Prices for conferences fees without overnight accomodation. (Based on availability)	from 70,00€	from 74,00€	from 82,00€	from 59,00€

LIVING HOTEL DÜSSELDORF

SPECIAL BREAKS

Coffee break hearty
/ Coffee and tea buffet
/ Various savory components
included in conference package

Coffee break sweet
/ Coffee and tea buffet
/ Various savory components
included in conference package

Coffee break Dusseldorf
/ Coffee and tea buffet
/ „Halve Hahn“, freshly squeezed orange juice
/ Curd pastry, Lye roll with cream cheese
plus 4,00€ per person

Coffee break chocolate
/ Coffee and tea buffet, hot chocolate
/ Brownies, various cookies
plus 2,00€ per person

Coffee break Vital
/ Coffee and tea buffet
/ Vegetable sticks with dip, granola bar, fresh fruits
plus 3,00€ per person

Breakfast coffee break
/ Coffee and tea buffet
/ different occupied baguette rolls
/ Croissants with jam selection, fruit salad, yogurt
8,00€ per person

Food and drinks

CONFERENCE DRINKS

Soft drinks	0,25 l	2,50 €
Mineral water	0,75 l	6,90 €
Apple juice	1,0 l	8,50 €
Other juices	1,0 l	8,50 €
Pot of coffee / tea	2,0 l	10,50 €

MENU AND BUFFET SUGGESTIONS

When compiling your personal menu or buffet, we are always happy to assist you. Of course, we complement your menus depending on the season according to your ideas and advise you in a personal conversation.

In our Michelin-star rated restaurant Agata's, an impressive, unique international cuisine is awaiting as well as an exquisite wine selection.



LIVING HOTELS®



Contact

Kirchfeldstraße 59-61
D-40217 Dusseldorf
+49 (0)211-41729-580

convention.sales.due@living-hotels.com
living-hotels.com



LIVING-HOTELS.COM